

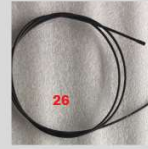

## Bintelli Trio Electric Bicycle Parts Manual



Item	Part name	BAOGL NO.	Specification	Unit per bike	Material
1	N/A	N/A	for front wheel 24", rear wheel 20"	1	Aluminum
2	Swing System Fixing Block	BB-550	Block that holds pivot pin in place	1	Steel
3	Blue Front Fork Assembly	BB-353-Blue	24inch, 28.6*165mm, 100mm ,threaded, Blue	1	Aluminum
	Silver Front Fork Assembly	BB-353-Silver	24inch, 28.6*165mm, 100mm ,threaded, silver		
4	Seat	BB-40	KS9035E ,black	1	
5	Seat Post	BB-355	SP-594, 27.2*300mm , suspension, lift up, black	1	Aluminum
6	Seat Post Clamp	BB-08	31.8, black, 319Q	1	Aluminum
7	Hexgaon Screw	BB-551	M12*40mm	1	
8	Flat Washer	BB-552	4*13*55mm	1	connect frame front part and rear part
9	Spring Washer	BB-553	12mm	1	
10	Stainless Hexagon Screw	BB-554	M6*18mm	8	
11	Stainless Flat Washer	BB-524	6mm	8	attach the swing device
12	Stainless Spring Washer	BB-556	6mm	8	



Item	Part name	BAOGL NO.	Specification	Unit per bike	Material
13	Handlebar	BB-49	Aluminum color, T320 22.2*25.4*580	1	Aluminum
14	Handle Stem	BB-48	Threaded, threaded, adjustable, aluminum color, MQ-527	1	Aluminum
15	Handlebar Grip Set (L and R)	BB-206	VLG- 1389D2/130 length, black	1	Rubber
16	Left Brake Lever	BB-356	P82PP, 1650mm, Left	1	
	Right Brake Lever	BB-356-Right	P82PP, 1650mm, Right	1	
17	Thumb Throttle	BB-357	130X left hand operating, cable 1650 mm	1	
18	Display C961	BB-358	C961 48V, cable 1550mm button cable 300mm	1	Plastic
19	Shifter w/Transmission Cable	BB-30	ASLTX50R7CT, 7speed, cable 2000mm	1	
20	Bell (Ring)	BB-87			
21	Swing Device Shifter with Cable	BB-359	ASLTZ500LNB, left hand operating, line 2400mm	1	
22	Bowl Set	BB-360	K2A-TB threaded, black, with cap	1	
22-1	Bowl Cap	BB-361			
23	Front Brake Line	BB-362	outer 950mm inner 1100mm	1	
24	Rear Brake Line	BB-363	outer 2100mm inner 2250mm	1	
25	Transmission line	BB-364	1980mm	1	
26	Swing Device Cable Housing	BB-365	1800mm	1	

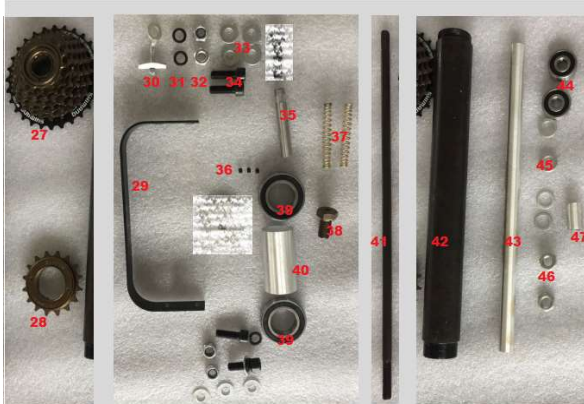

Item	Part name	BAOGL NO.	Specification	Unit per bike	Material
27	Cassette (Flywheel)	BB-366	7speed, AMFTZ5007428	1	Steel
28	Cassette (Flywheel)	BB-367	16T, single speed	1	
29	Torsion Bracket	BB-542		1	Steel
30	Screw for Chain	BB-543		1	
31	Spring Washer	BB-544	10mm	4	
32	Lock Nut	BB-545	10mm	4	
33	Flat Washer	BB-546	ø10*1mm	4	
34	Hexgon Screw	BB-547	M10*30mm	4	
35	Pin for Swing System	BB-548		1	Steel
36	Hexgon Screw	BB-549	M3*5	3	
37	Swing Device Spring	BB-368		2	
38	Screw	BB-541	M14*30, with the inner hole for cable	1	
39	Bearing	BB-369	13*30*55	2	
40	Bushing	BB-538		1	
41	Transmission shaft I	BB-539	ø10*395mm (threaded at both end), black	1	Steel
42	Transmission shaft II	BB-539-2	black	1	
43	Transmission shaft sleeve, long	BB-540	ø16*301.5mm	1	
44	Bearing	BB-370	10*10*30	2	
45	Flat washer	BB-546	ø10*1mm	4	
46	Stainless cross head nut	BB-536	ø10mm	2	
47	Transmission shaft sleeve, short	BB-537	ø16*25mm	1	

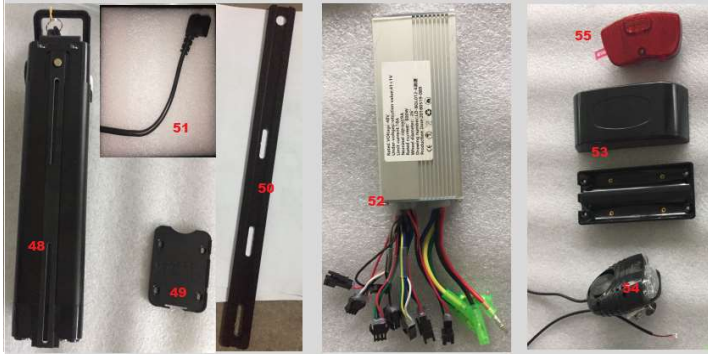

Item	Part name	BAOGL NO.	Specification	Unit per bike	Material
48	Battery	BB-371	48V10AH ,lithium	1	
	Battery Box	BB-622	Aluminum shell 245mm, black	1	
	Battery Fuse	BB-507		1	
49	Battery Lock and Key	BB-372		1	
	Battery Box Fixing Base	BB-372		1	
50	Battery Box Fixing Bracket	BB-373		1	
51	Battery Cable	BB-374	500mm	1	
52	Controller 48V18A	BB-375	48V18A 9mofest (headlight controlled)	1	Aluminum
53	Controller Box	BB-18-1	KZQ-3	1	Plastic
54	LED Headlight	BB-376		1	
55	LED Rear Light	BB-377	410	1	
56	Stainless Cross Head Screw	BB-532	M5*14mm, fix controller box to frame	4	
57	Cross Screw	BB-533	M4*8mm, assemble the controller box	4	

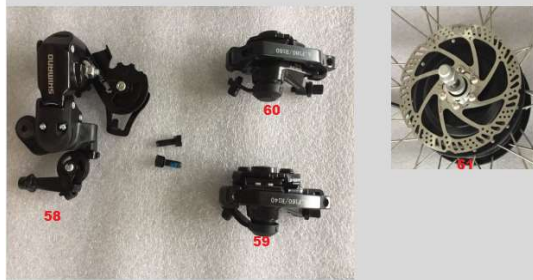

Item	Part name	BAOGL NO.	Specification	Unit per bike	Material
58	Deraillieur,with screw	BB-378	ARDFT35AD	1	
59	Front Disk Brake	BB-148	Front A-F160-R140	1	steel
60	Rear Disk Brake	BB-147	Rear A-F180-R160	1	steel
	Brake Pad Set	BB-407	Set of 2 pads	1	
61	Brake Disk (Rotor)	BB-455	160mm,with fixing screws	1	

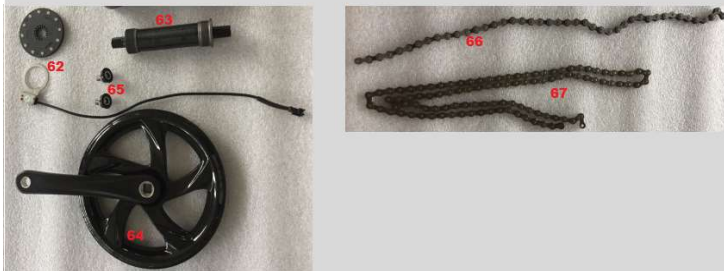

Item	Part name	BAOGL NO.	Specification	Unit per bike	Material
62	Speed sensor	BB-864	400mm	1	
63	B.B shaft	BB-379	120*175mm	1	steel
64	Crank	BB-380	44T*152mm matt black, dual shield, PRO-E44PP	1	Aluminum
65	Screw for Crank	BB-531		2	
66	Chain	BB-381	single, 42 knots	1	Steel
67	Chain	BB-382	7speed, 102knots,	1	Steel



Item	Part name	BAOGL NO.	Specification	Unit per bike	Material
68	Rear Basket	BB-383	black, with cover, with fixing hardware,incl 68-1,68-2	1	Steel
68-1	Rear Carrier Fixing Clamp	BB-530	connect rear basket and cover, with screw	2	Steel
68-2	Rear Basket Holder Piece	BB-384	black	2	Steel
69	Front Basket Bracket	BB-386	silver	1	
70	Front Basket	BB-385	black, with cover and hardware in set	1	Steel
71	Front Basket Holder Bracket	BB-529	silver 28.6, with rubber	1	steel
72	Stainless Hexagon Screw	BB-523	M6*20mm	4	
73	Stainless Flat Washer	BB-524	ø6mm	4	
74	Stainless Lock Nut	BB-525	ø6mm	4	



Item	Part name	Bintelli Part #	Specification	Unit per bike	Material
75	Front Wheel Assembly with Motor	BB-387	24", 36holes, dual, 12g,5.2 disc brake	1	Aluminum
76	Right Rear Wheel Assembly	BB-527	20", 36holes,dual,13g, 5.0 disc brake, P25DE	2	Aluminum
77	Tyre 24"*1.75	BB-389	24*1.75 , K924	1	Rubber
78	Inner tube 24" with liner band	BB-390	24*1.75, K924	1	Rubber
79	Tyre 20"*1.75	BB-391	20*1.75, K924	2	Rubber
80	Inner tube 20" with liner band	BB-392	20*1.75, K924	2	Rubber
81	Reflector	BB-393	White	3	pls
82	Motor,48V500W for 20" wheel	BB-394	48V500W , 24", disc brake, 12G 36 holes,	1	Aluminum
83	Rear Hub for Cassette	BB-396	JA159F-DSS/3/8*13*36*125*170	1	Aluminum
84	Rear Hub for Disk Brake	BB-397	PCSJA189R-SS/3/3813*36*125*170	1	Aluminum
85	Front Spoke 24"	BB-398	Front, 24", 12G 173mm , for front motor	36	
86	Rear Spoke 20"	BB-399	Rear, 13G 160/162, for rear hub	36	
	Left Rear Wheel Assembly	BB-528	With Cassette		





Item	Part name	BAOGL NO.	Specification	Unit per bike	Material
90	Front Wheel Fender	BB-400	24" *55	1	
91	Rear Wheel Fender	BB-401	20" *55	2	
92	Rear Fender Bracket (Black, over frame strap)	BB-522		4	
93	Fixing bracket,front fender	BB-402		1	
	Stainless hexgon screw	BB-512	connect fender bracket to front fork, M5*10mm	2	
	Stainless Flat Washer	BB-516	connect fender bracket to front fork, ø5mm	2	
	Stainless Cross Screw (with fixing part )	BB-514	connect fender bracket to front fork, M5*8mm	2	
	Stainless Hexagon Screw	BB-515	connect front fender to front fork, M5*55mm	1	
	Stainless Flat Washer	BB-516	connect front fender to front fork, ø5mm	1	
	Stainless Lock Nut	BB-517	connect front fender to front fork, ø5mm	1	
	Stainless Screw	BB-518	connect rear fender to frame, M5*8mm	8	
	Stainless Lock Nut	BB-517	connect rear fender to frame, ø5mm	8	



Item	Part name	BAOGL NO.	Specification	Unit per bike	Material
102	Bottle holder	BB-212	black	1	
103	Bottle			1	
104	Stainless Hexgon Screw	BB-512	M5*10mm	2	
105	Stainless Flat Washer	BB-516	ø5mm	2	
106	Charger	BB-403	48V2A, American standard	1	
	Charger	BB-502	48V5AH, Alloy Shell with DC plug	Optional	
107	Tool kits	BB-404		1	
108	Manual	BB-405		1	
109	Pedal Set	BB-253	Aluminum color, both left and right side	1	

Hardware

	Cross Head Screw	BB-534	M4*16mm		
	Flat Washer 12*2mm	BB-535	12*2mm		